

Ghost

Design by Arik Levy

A study in contrasts, the Ghost collection embodies both spirit and materiality, discretion and presence. A contemporary reimagining of the grand lights that once graced entryways and living areas, its sensuous form radiates with a warm, welcoming glow.

Table



4960

Ø 47,5 x 112 cm



4965

Ø 47,5 x 92 cm



4970

Ø 47,5 x 88 cm

Dimming and installation options



/15: Push-dimming model equipped with two buttons, one for each diffuser. A quick push turns the light on and off, a longer presson dims the light.

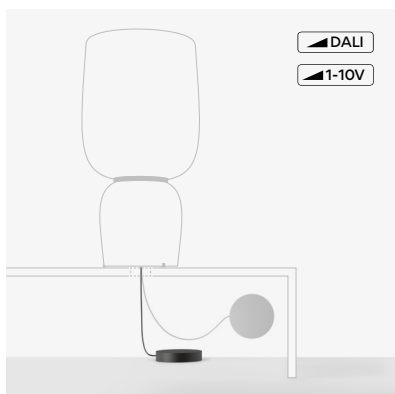

Dimming and installation options: The driver of the DALI-2, 1-10V and Casambi versions is enclosed in a box at the end of the cable.

4960

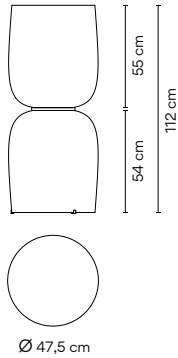

Finishes
 ● 11/ __ Black
 (NCS S 8500-N)

LED Colour Temperature
 /1 _ 2700 K - 5432,0 lm
 [D] >
 CRI >90

Control
 4960 __ / __

- __ / _ 1 DALI-2
- __ / _ 3 1-10V
- __ / _ 5 Push
(with or without memory)
- __ / _ Z Casambi

Materials
 Diffuser: Opal Glass.
 Metal parts: Aluminum.

Packaging
 2 Boxes
 Total Vol 0,6051 m³
 Gross weight 25,7 Kg Net weight 22,7 Kg

Light Source and electronics
 2 x LED 19,8 W 800 mA
 Constant Current 800 mA
 100~240V 50/60Hz

Notes
 A colour glass diffuser can be placed in the lower glass for an amber or burgundy light effect.
 Electric cable 2 m.



4965

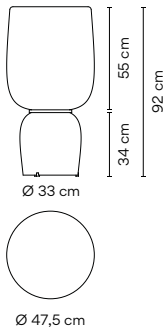

Finishes
 ● 11/ __ Black
 (NCS S 8500-N)

LED Colour Temperature
 /1 _ 2700 K - 5432,0 lm
 [D] >
 CRI >90

Control
 4965 __ / __

- __ / _ 1 DALI-2
- __ / _ 3 1-10V
- __ / _ 5 Push
(with or without memory)
- __ / _ Z Casambi

Materials
 Diffuser: Opal Glass.
 Metal parts: Aluminum.

Packaging
 2 Boxes
 Total Vol 0,6051 m³
 Gross weight 20,6 Kg Net weight 17,6 Kg

Light Source and electronics
 2 x LED 19,8 W 800 mA
 Constant Current 800 mA
 100~240V 50/60Hz

Notes
 A colour glass diffuser can be placed in the lower glass for an amber or burgundy light effect.
 Electric cable 2 m.



4970

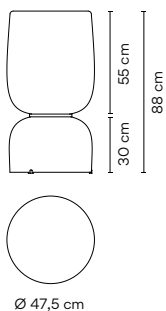

Finishes
 ● 11/ __ Black
 (NCS S 8500-N)

LED Colour Temperature
 /1 _ 2700 K - 5432,0 lm
 [D] >
 CRI >90

Control
 4970 __ / __

- __ / _ 1 DALI-2
- __ / _ 3 1-10V
- __ / _ 5 Push
(with or without memory)
- __ / _ Z Casambi

Materials
 Diffuser: Opal Glass.
 Metal parts: Aluminum.

Packaging
 2 Boxes
 Total Vol 0,6051 m³
 Gross weight 21,7 Kg Net weight 18,7 Kg

Light Source and electronics
 2 x LED 19,8 W 800 mA
 Constant Current 800 mA
 100~240V 50/60Hz

Notes
 A colour glass diffuser can be placed in the lower glass for an amber or burgundy light effect.
 Electric cable 2 m.

