

Flat

Design by Ichiro Iwasaki

Flat's distinctive, disc-shaped diffusers form horizontal planes of light that integrate with the surrounding architecture. A study in geometry, the collection creates layers of light that infuse a space with a soothing, Zen sensitivity.

Ceiling

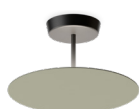

5920

Ø 40 cm



5915

Ø 55 cm



5926

Ø 90 cm



5905

101 x 88 cm

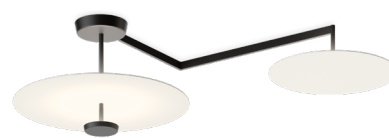

5910

106 x 90 cm

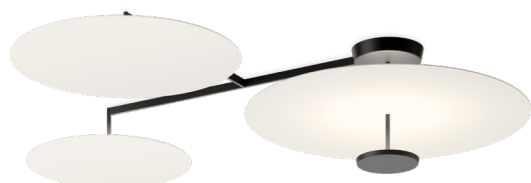

5922

178 x 149 cm



5924

186 x 149 cm

5905

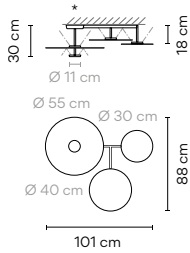

Finishes

- 10/ _ _ White (NCS S 0300-N)
- 71/ _ _ White, Green L1, Off-White (NCS S 0300-N, NCS S 4005-G80Y, NCS S 1000-N)

LED Colour Temperature

- /1_ 2700 K - 5906 lm
- E
- /3_ 3500 K - 6344 lm
- F
- CRI >90

Control

5905 _ _ / _ A Push; 1-10V; DALI-2

Materials

Shade: Aluminum.
 Diffuser: PC- Polycarbonate.
 Structures: Steel.
 Canopy: Aluminum.

Light Source and electronics
 4 x LED PLATE 13,5 W 700 mA
 Constant Current 700 mA
 110-240V 50/60Hz

Packaging

1 Box 0,75 x 0,45 x 0,25 m
 Vol 0,0844 m³
 Gross weight 17,15 Kg Net weight 15,38 Kg

Notes

* Electrical connection point



5910

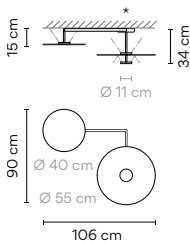

Finishes

- 10/ _ _ White (NCS S 0300-N)
- 72/ _ _ White, Green L1 (NCS S 0300-N, NCS S 4005-G80Y)
- 73/ _ _ White, Off-White (NCS S 0300-N, NCS S 1000-N)

LED Colour Temperature

- /1_ 2700 K - 4430 lm
- E
- /3_ 3500 K - 4758 lm
- F
- CRI >90

Control

5910 _ _ / _ A Push; 1-10V; DALI-2

Materials

Shade: Aluminum.
 Diffuser: PC- Polycarbonate.
 Structures: Steel.
 Canopy: Aluminum.

Light Source and electronics
 3 x LED PLATE 13,5 W 700 mA
 Constant Current 700 mA
 110-240V 50/60Hz

Packaging

1 Box 0,80 x 0,70 x 0,30 m
 Vol 0,1680 m³
 Gross weight 11,90 Kg Net weight 9,10 Kg

Notes

* Electrical connection point



5915

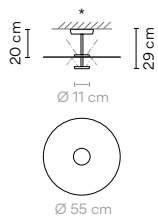

Finishes

- 10/ _ _ White (NCS S 0300-N)

LED Colour Temperature

- /1_ 2700 K - 2953 lm
- E
- /3_ 3500 K - 3172 lm
- F
- CRI >90

Control

5915 10 / _ A Push; 1-10V; DALI-2

Materials

Shade: Aluminum.
 Diffuser: PC- Polycarbonate.
 Structures: Steel.
 Canopy: Aluminum.

Light Source and electronics
 2 x LED PLATE 13,5 W 700 mA
 Constant Current 700 mA
 110-240V 50/60Hz

Packaging

1 Box 0,65 x 0,65 x 0,25 m
 Vol 0,0106 m³
 Gross weight 6,80 Kg Net weight 4,73 Kg

Notes

* Electrical connection point



5920

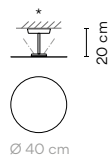

- Finishes**
- 10/ __ White (NCS S 0300-N)
 - 13/ __ Off-White (NCS S 1000-N)
 - 47/ __ Green L1 (NCS S 4005-G80Y)

LED Colour Temperature

/1 _ 2700 K - 1740 lm
/3 _ 3500 K - 1868 lm

E

CRI >90

Control

5920 __ / __

__ / __ 1 DALI-2
__ / __ B Push; 1-10V

Materials

Shade: Aluminum.
Diffuser: PC- Polycarbonate.
Structures: Steel.
Canopy: Aluminum.

Light Source and electronics

1 x LED PLATE 13,5 W 700 mA
Constant Current 700 mA
110-240V 50/60Hz

Packaging

1 Box 0,45 x 0,45 x 0,25 m
Vol 0,0051 m³
Gross weight 3,10 Kg Net weight 1,91 Kg

Notes

* Electrical connection point



5922

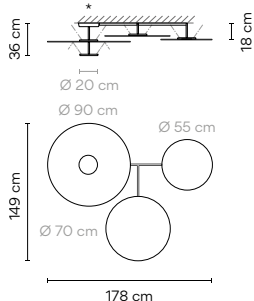

- Finishes**
- 10/ __ White (NCS S 0300-N)
 - 71/ __ White, Green L1, Off-White (NCS S 0300-N, NCS S 4005-G80Y, NCS S 1000-N)

LED Colour Temperature

/1 _ 2700 K - 13920 lm
/3 _ 3500 K - 14951 lm

D

CRI >90

Control

5922 __ / __

__ / __ A Push; 1-10V; DALI-2
__ / __ Z Casambi

Materials

Shade: Aluminum.
Diffuser: PC- Polycarbonate.
Structures: Steel.
Canopy: Aluminum.

Light Source and electronics

4 x LED PLATE 25 W 700mA
Constant Current 700 mA
110-240V 50/60Hz

Packaging

1 Box 1,35 x 1,20 x 0,30 m
Vol 0,0486 m³
Gross weight 26,60 Kg Net weight 19,98 Kg

Notes

* Electrical connection point



5924

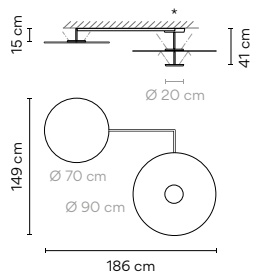

- Finishes**
- 10/ __ White (NCS S 0300-N)
 - 72/ __ White, Green L1 (NCS S 0300-N, NCS S 4005-G80Y)
 - 73/ __ White, Off-White (NCS S 0300-N, NCS S 1000-N)

LED Colour Temperature

/1 _ 2700 K - 9897 lm
/3 _ 3500 K - 10630 lm

E

CRI >90

Control

5924 __ / __

__ / __ A Push; 1-10V; DALI-2
__ / __ Z Casambi

Materials

Shade: Aluminum.
Diffuser: PC- Polycarbonate.
Structures: Steel.
Canopy: Aluminum.

Light Source and electronics

3 x LED PLATE 25 W 700mA
Constant Current 700 mA
110-240V 50/60Hz

Packaging

1 Box 1,45 x 1,10 x 0,25 m
Vol 0,0399 m³
Gross weight 27 Kg Net weight 20,80 Kg

Notes

* Electrical connection point



5926

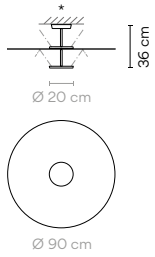

Finishes
 ● 10/ _ _ White
 (NCS S 0300-N)

LED Colour Temperature
 /1_ 2700 K - 6598 lm
 [D]
 /3_ 3500 K - 7086 lm
 [E]
 CRI >90

Control
 5926 10 / _ A Push; 1-10V; DALI-2

Materials
 Shade: Aluminum.
 Diffuser: PC- Polycarbonate.
 Structures: Steel.
 Canopy: Aluminum.

Light Source and electronics
 2 x LED PLATE 25 W 700 mA
 Constant Current 700 mA
 110-240V 50/60Hz

Packaging
 1 Box 1,05 x 1,05 x 0,25 m
 Vol 0,0276 m³
 Gross weight 14,60 Kg Net weight 10,08 Kg

Notes
 * Electrical connection point

